

2D/3D CAD Drawings at nookindustries.com

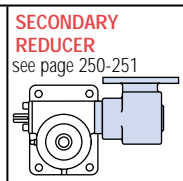
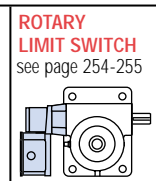
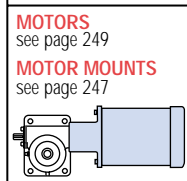
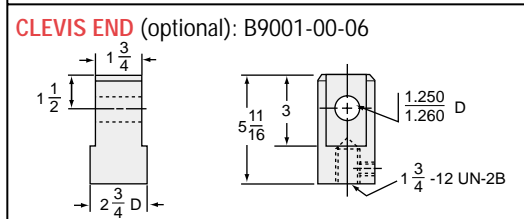
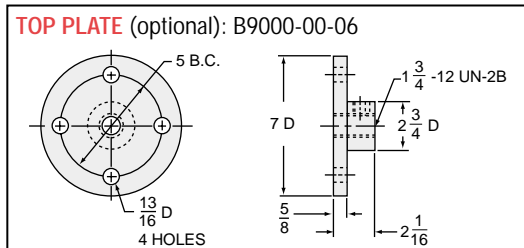
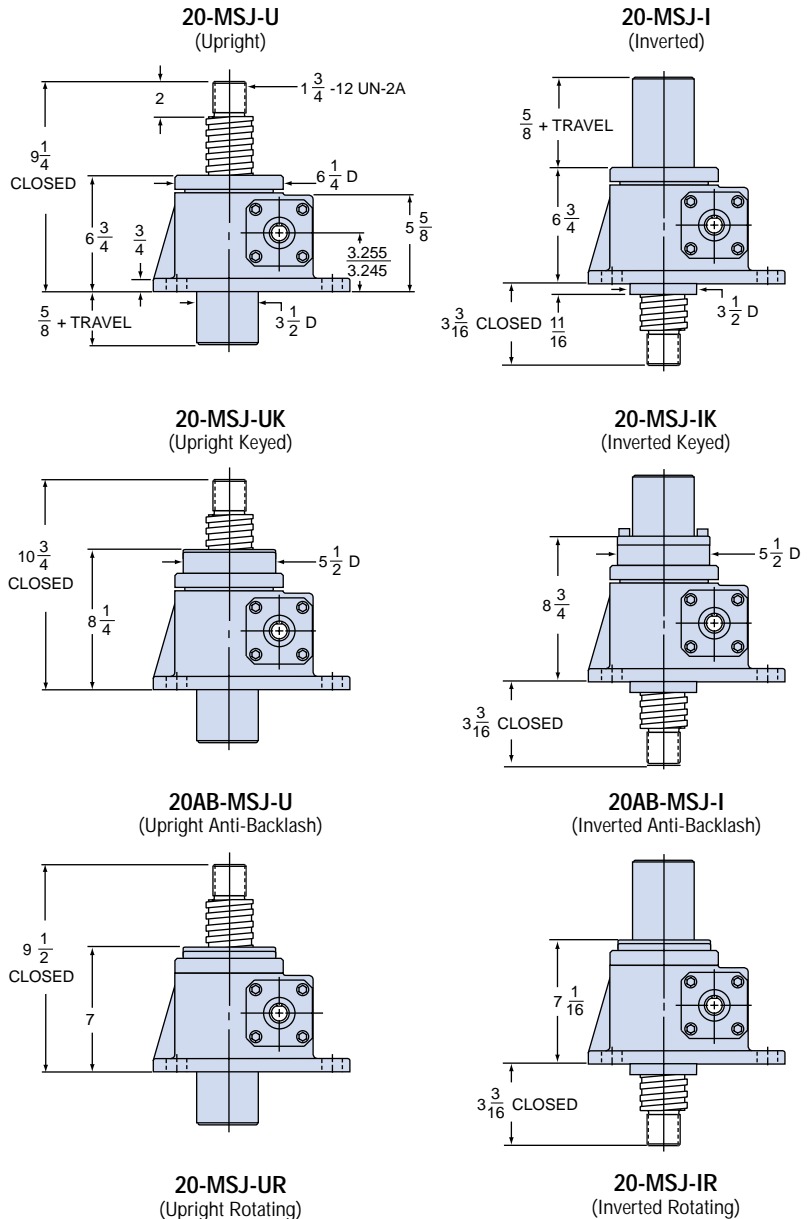

FOR ORDERING SPECIFY "L" DIMENSION  
 $L$  (min) = TRAVEL +  $11 \frac{1}{4}$

FOR ORDERING SPECIFY "L" DIMENSION  
 $L$  (min) = TRAVEL +  $5 \frac{3}{16}$

ACME NUT POSITION A, SPECIFY POSITION B FOR OPPOSITE

**20-MSJ STANDARD SCREW**  
SCREW:  $2 \frac{1}{2}$  - 2  
ROOT DIAMETER: 1.908  
DRAG TORQUE: 40 IN.-LB.  
START TORQUE: 2 x Running Torque  
WEIGHT (Approx. in Pounds)  
"0" TRAVEL: 80.0  
PER INCH TRAVEL: 1.8  
GREASE: 2.25

RATIO	TURNS OF WORM PER INCH TRAVEL	TORQUE TO RAISE ONE LB.		MAX. HP	MAX. WORM SPEED AT RATED LOAD		MAX. LOAD AT 1750 RPM	
		NON-KEYED	KEYED		NON-KEYED	KEYED	NON-KEYED	KEYED
8:1	16	.0435 in.-lbs.	.0500 in.-lbs.	7 1/2	272 rpm	236 rpm	6209 lbs.	5402 lbs.
24:1	48	.0218 in.-lbs.	.0251 in.-lbs.	2 1/2	180 rpm	157 rpm	4130 lbs.	3587 lbs.

LIFTING SCREW OR NUT MUST BE SECURED TO PREVENT ROTATION FOR NON-KEYED UNITS.  
**CAUTION!** JACK MAY BE SELF-LOWERING IN SOME OPERATING CONDITIONS.